

MEETING AND EVENT PLANNER



Native American tribes knew the merit of meeting in inspirational surroundings. Today many groups still meet at Quartz Mountain, but although the lush landscape remains, the accommodations have undergone a transformation. Step inside the Quartz Mountain Resort Arts & Conference Center and you'll immediately feel pampered. Your surroundings are rustic, yet elegant. The service is exceedingly efficient, yet unobtrusive, enhancing our award-winning conference facilities and exceptional culinary capabilities.

ACCOMMODATIONS

- ⊗ 118 elegantly appointed lake-side or mountain-side guest rooms
- ⊗ Two phones with data ports
- ⊗ Two phone lines
- ⊗ In-room coffee maker
- ⊗ 11 rustic cabins and dormitory-style bunkhouse

ATTRACTIONS

- ⊗ 6,400 acre Lake Altus-Lugert
- ⊗ Scenic dining in Sundance Café
- ⊗ Appetizers and beverages in Sundance Lounge
- ⊗ Trading Post gift shop
- ⊗ Extensive art collection
- ⊗ Nature center with year-round programs and activities

RECREATION

- ⊗ 18-hole golf course with lighted driving range
- ⊗ Heated swimming pool and whirlpool
- ⊗ Nature and interpretive hiking
- ⊗ Cave exploration
- ⊗ Water slides, mini golf, go-carts and paddleboats (May-October)
- ⊗ Eagle watching (November-March)
- ⊗ Bass and trout fishing
- ⊗ Biking trails
- ⊗ Boating on Lake Altus
- ⊗ Horseback riding
- ⊗ On-site Activities Instructor
- ⊗ Rock climbing



LAKE ALTUS AT LONE WOLF, OKLAHOMA

22469 Lodge Road ⊗ Lone Wolf, Oklahoma 73655
 Phone: 580.563.2424 ⊗ Fax 580.563.2422

Toll Free: 877.999.5567

www.QuartzMountainResort.com

Conveniently located just a few hours from Oklahoma City, Dallas, Fort Worth and Amarillo, Quartz Mountain Resort Arts & Conference Center offers the ideal setting for meetings, weddings and events.

QUARTZ MOUNTAIN SITE PLAN



MEETING AND EVENT FACILITIES

Offering easy access from Tulsa, Oklahoma City, Dallas and Amarillo, Quartz Mountain Resort Arts & Conference Center provides an exquisite setting ideal for meetings, weddings and other events. Along with the resort's array of activities, our land is rich with things to see and do. Delight and motivate your guests by booking a golf outing on our challenging 18-hole golf course. Compete for the catch of the day - the lake is fully stocked with bass and trout. Take a refreshing swim in our indoor pool. Explore the rugged beauty of a cave or spy a majestic eagle soaring over the water. Whatever diversion you choose, you'll feel rejuvenated at day's end.

- ⊗ 16,000 sq. ft. of meeting and event space
- ⊗ 4,800 sq. ft. Grand Ballroom (converts to 5 breakout rooms)
- ⊗ 2,360 sq. ft. pre-function area
- ⊗ 5 enclosed group pavilions with lake views
- ⊗ Catering, audio-visual and business services
- ⊗ Twin Peaks Performance Hall with seating for 697 guests
- ⊗ Open air amphitheater

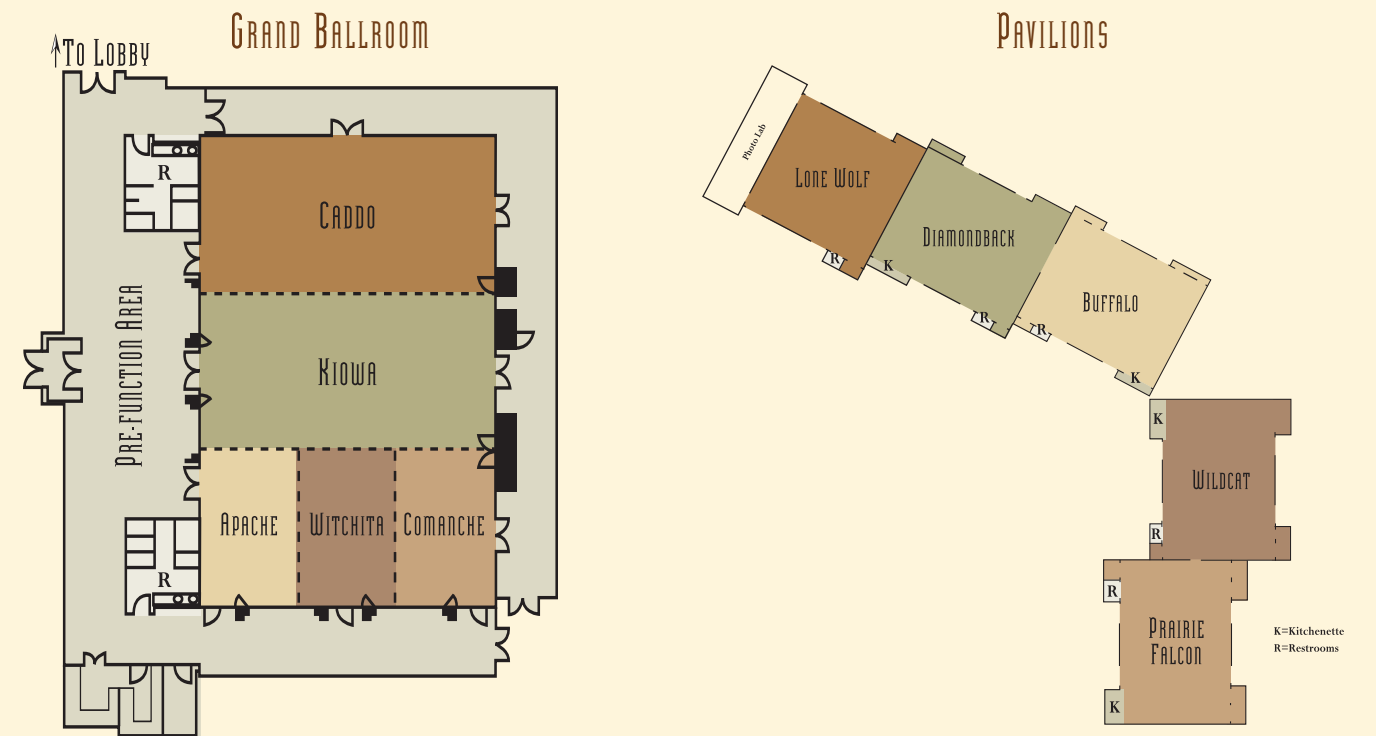

Meeting Room	Dimensions	Square Feet	Theater	Classroom	Conference	U-Shape	Rounds	Hollow Square
Grand Ballroom	87' x 56'	4,872	550	300	144	145	430	180
Caddo	29' x 56'	1,624	180	120	48	50	140	60
Kiowa	29' x 56'	1,624	180	120	48	50	140	60
Apache	18' x 29'	522	60	40	16	15	40	20
Wichita	18' x 29'	522	60	40	16	15	40	20
Comanche	18' x 29'	522	60	40	16	15	40	20
<i>Pavilions: All enclosed with central heat & air and private decks offering superior lake views</i>								
Prairie Falcon	50' x 40'	2,000	150	100	60	85	120	90
Wildcat	50' x 40'	2,000	150	100	60	85	120	90
Buffalo	50' x 40'	2,000	150	100	60	85	120	90
Diamondback	50' x 40'	2,000	150	100	60	85	120	90
Lone Wolf	50' x 36'	1,800	135	85	45	70	120	75
Badger Library	20' x 34'	680	NA	NA	20	NA	NA	NA
Gallery	11' x 23'	253	20	15	15	NA	20	NA
Twin Peaks Performance Hall	140' x 180'	25,200	697	NA	NA	NA	NA	NA